

MAP-WAS | AUDIO STREAMER

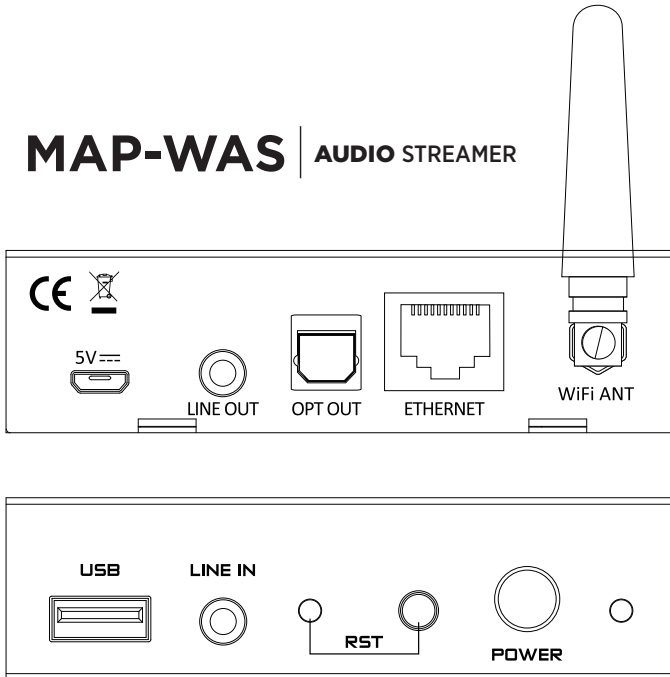

DEAR CUSTOMER

Thank you for purchasing this product. For optimum performance and safety, please read these instructions carefully before connecting, operating or adjusting this product. Please keep this manual for future reference.

WARNING

1. Do not expose this unit to water, moisture, or excessive humidity.
2. Do not install or place this unit in a built-in cabinet, or other confined space without adequate ventilation.
3. To prevent risk of electrical shock or fire hazard, due to overheating do not obstruct unit's ventilation openings.
4. Do not install near any source of heat, including other units that may produce heat.
5. Do not place unit near flames.
6. Only clean unit with a dry cloth.
7. Unplug unit during lightening storms or when not used for an extended period of time. A surge protector is strongly recommended.
8. Protect the power cord from being walked on or pinched, particularly at the plugs.
9. Use unit only with accessories specified by the manufacturer.
10. Refer all servicing to qualified personnel.

CAUTION

CAUTION: TO REDUCE THE RISK OF ELECTRIC SHOCK,
DO NOT REMOVE COVER (OR BACK).
NO USER-SERVICEABLE PARTS INSIDE.
REFER SERVICING TO QUALIFIED SERVICE PERSONNEL.



INTRODUCTION

This MAP-WAS audio streamer performs in great sound quality and especially designed to meet the high demand of personal entertainment and installation market, and makes multi-room streaming easy. The same music can be distributed to all zones or different music to different zones, even the music files from the local storage, such as smart phone, USB flash dis, NAS or the most popular streaming services. Simply connecting 3.5mm and Optical output to amplifiers, with free iOS and android APP for the ability to control streaming options and enjoying the music.

FRONT PANEL FEATURES

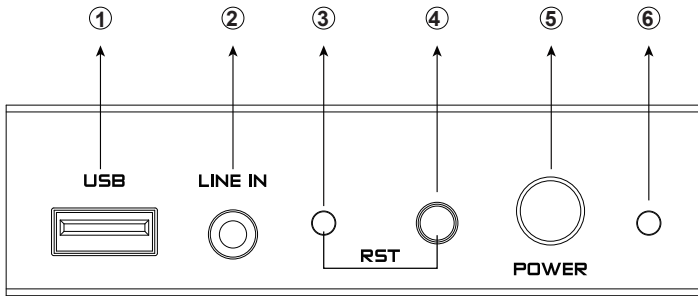

- 1. USB port:** Connecting with local storage device.
- 2. 3.5mm Line in:** Connecting with the source device with analogue output.
- 3. Input status LED:** Blue - Wi-Fi
Red - USB
Purple - Line in

Note: After pressing RST button, the device will back to default value and LED will flash rapidly.

- 4. RESET:** Reset the device when it has problem in Wi-Fi connection.
- 5. Power button:** Press to turn on/off the device.
- 6. Power LED:** Lights on when the unit power on.

REAR PANEL FEATURES

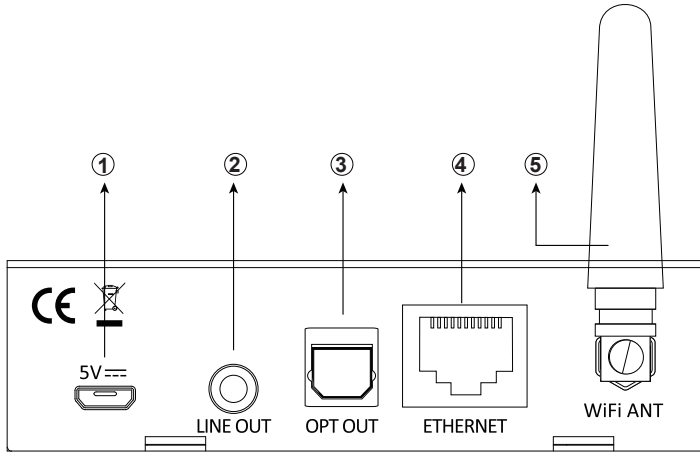

- 1. Power Input:** Connecting with the external power supply.
- 2. 3.5mm Line out:** Providing analogue signal to amplifier or other receiver.
- 3. Optical out:** Provides digital signal to other device with Optical input.
- 4. Ethernet port:** RJ-45, for wired connecting with the network.
- 5. Wi-Fi Antenna:** For wireless connecting with the network.

CONNECTION DIAGRAM

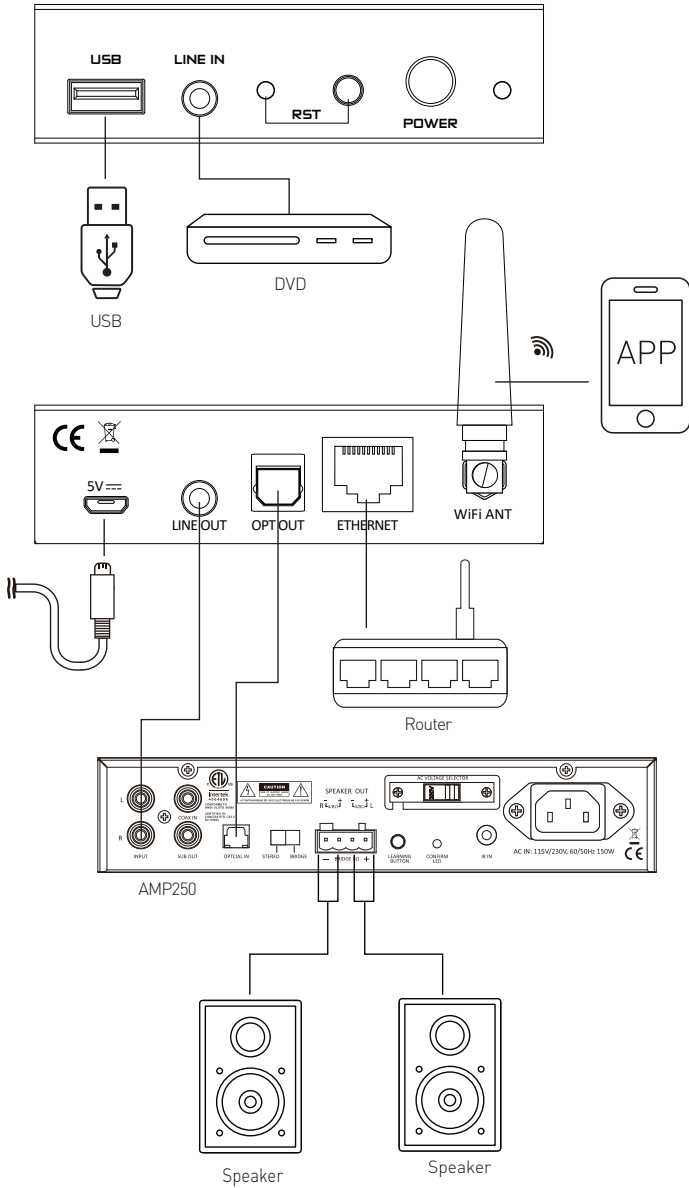

APPLICATION SETTING

Download the App

Download the MUZO application from the App Store for iOS and Google Play for Android.



Configuration (Wireless)

* Connect your mobile device to local network and open the APP, power on MAP-WAS. Please follow the instruction on the APP, press "Add Device":

* Change the device's Wi-Fi setting, and select the Wi-Fi of MAP-WAS to connect:

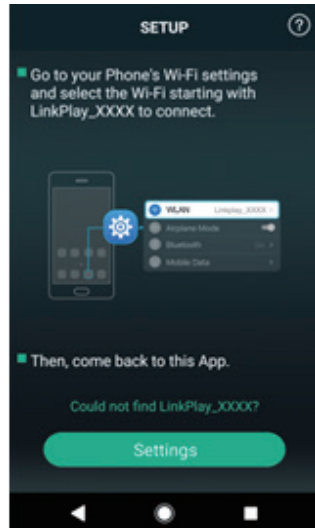
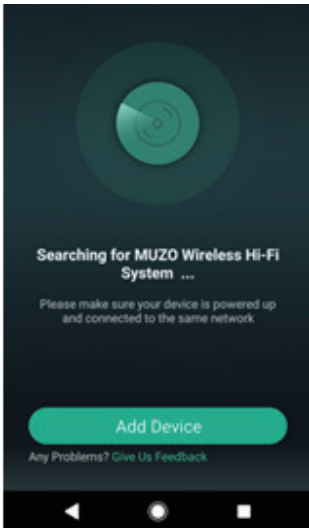

* Choose the network and enter the password:

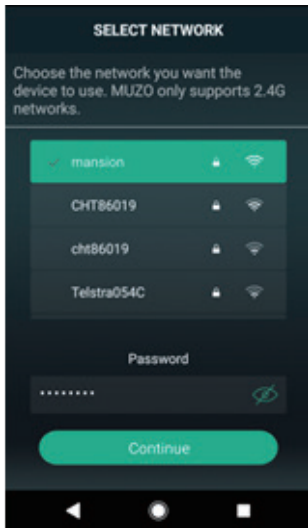

* Waiting for a few seconds for connecting:

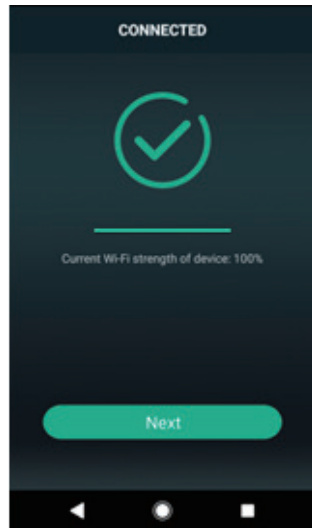

* Settings successful.

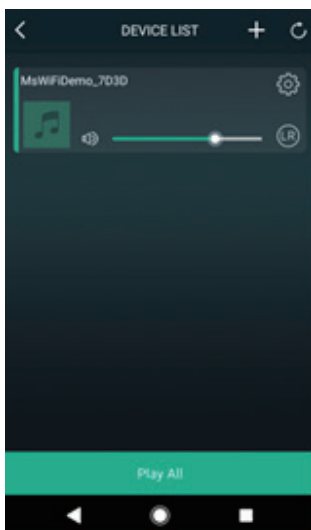

Configuration (Wired)

- * Power on MAP-WAS
- * Using good quality of Cat5 Cable, connect the device with the router, the device will show on the app in about 10seconds.

FEATURE:

- * Pocket size/low power designed.
- * APP for device and streaming management.
- * Wi-Fi or LAN connection to Ethernet.
- * USBport for playing music from storage device.
- * 3.5mm audio Line input for connection to source devices.
- * LED indicates the status of the input sources.
- * Optical and 3.5mm outputs for connections to other audio systems.
- * Support Apple Airplay, DLNA
- * Easy Wi-Fi set up by pressing RESET button.

SPECIFICATIONS:

Total Harmonic Distortion (THD):<0.09% (3.5mm Jack output)

<0.05% (Optical output)

Signal to Noise: >80 dB A WTD (3.5mm Jack output)

>90 dB A WTD (Optical output)

Frequency Response:20Hz-22KHz

Source in: Audio Streamer, 3.5mm Jack Line input, USB

Music file format: Support MP3 / WMA / AAC / AAC + / ALAC / FLAC / APE / WAV

Wireless Network: Support 802.11b/g/n.

Ethernet Port: RJ-45

Compatible with Apple Airplay, DLNA

Dimension: 92.5mm x25.2mm x 68.1mm (WxHxD)

Weight: 0.5Kgs